

Date:
March 12, 2012

Technical Newsletter

No:
34:1



www.grindex.com

Subject:

New seal sleeves for cable diameters 10-26 mm on
Minex – Major & Salvador - Sandy

Dear Distributor,

The seal sleeves for cable diameter 10-26 mm are modified to improve the cable entry on the pump models Minex, Minette, Salvador, Minor, Major, Senior & Sandy. Cable clips and washers remain same.

Reason for change

Improve the sealing of the cable entry for cables.

Pumps concerned

Minex 8101.171, Minette 8102.171, Salvador 8109.281

Minor 8103.180, Major 8104.180, Senior 8110.280, Sandy 8111.180.

Time for change

The change was implemented from

- January 2011 from serial number 1110001 for

Minex 8101.171, Minette 8102.171, Salvador 8109.281

- March 2011 from serial number 1120001 for

Minor 8103.180, Major 8104.180, Senior 8110.280, Sandy 8111.180.

Spare parts

New Part number

Denomination	Part number
Seal sleeve (10)- 12 mm	410 727
Seal sleeve (12)- 14 mm	410 728
Seal sleeve (14)- 16 mm	410 729
Seal sleeve (16)- 18 mm	410 730
Seal sleeve (18)- 20 mm	410 731
Seal sleeve (20)- 22 mm	410 732
Seal sleeve (22)- 24 mm	410 733
Seal sleeve (24)- 26 mm	410 734

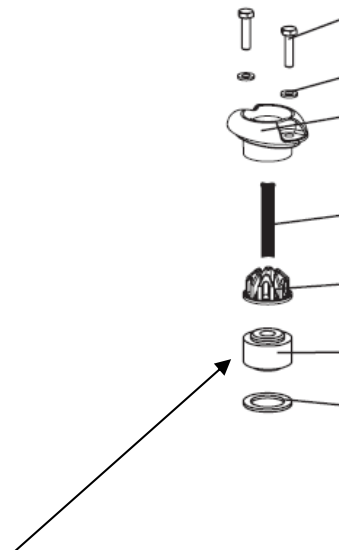

Date:
March 12, 2012

Technical Newsletter

No:
34:1



www.grindex.com

Subject:

New seal sleeves for cable diameters 10-26 mm on
Minex – Major & Salvador - Sandy

Replaced Part number

Denomination	Part number
Seal sleeve (10)- 12 mm	410 043
Seal sleeve (12)- 14 mm	410 044
Seal sleeve (14)- 16 mm	410 045
Seal sleeve (16)- 18 mm	410 046
Seal sleeve (18)- 20 mm	410 047
Seal sleeve (20)- 22 mm	410 048
Seal sleeve (22)- 24 mm	410 049
Seal sleeve (24)- 26 mm	410 050

Spare part lists are updated.

Interchangeability

The new cable seal sleeve is fully replacing the old seal sleeve. The old spare parts are not automatically replaced, due to that they are still used in some other products.

Yours sincerely,

Jonas Bladh

Technical Support